

Air Valve Seal Kits

406813D

Husky® 1050 and Husky® 15120 Diaphragm Pumps

EN

Kits 24B769 and 24C983



Important Safety Instructions

Read all warnings and instructions in the Husky® 1050 or Husky® 15120 Air-Operated Diaphragm Pump Repair/Parts manual. Save all instructions.

| Ref. | Description | Qty. |
|------|--|------|
| 206 | O-RINGS, end cap | 2 |
| 208 | U-CUPS, piston | 2 |
| 209 | SCREW | 2 |
| | Kit 24B769: M3 (shorter - for metal pumps) and #4 (longer - for plastic pumps) | |
| | Kit 24C983: M3 | |
| 219 | O-RING, for Kit 24B769 (used for DataTrak models with runaway protection) | 1 |
| 108 | GASKET, air valve (not shown) | 1 |
| --- | GREASE, lithium-based (not shown) | 1 |

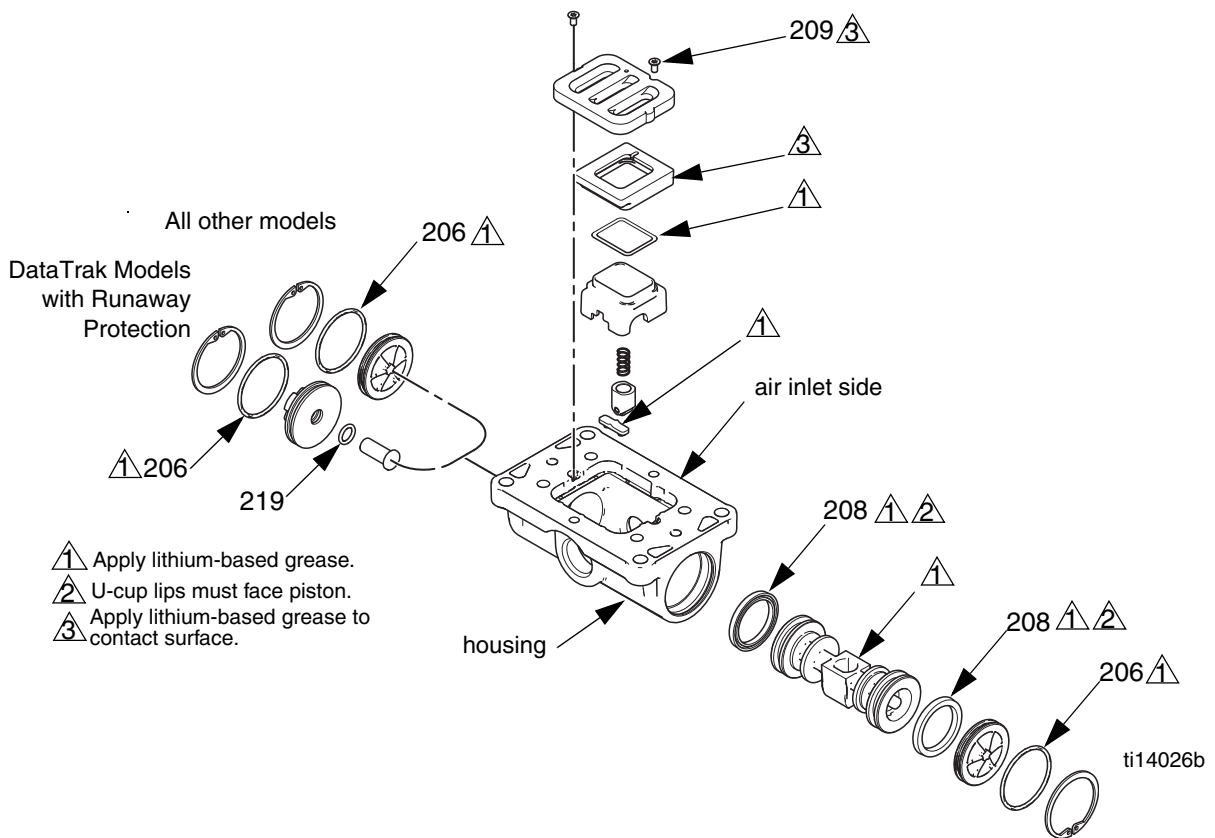

Graco Inc. P.O. Box 1441 Minneapolis, MN 55440-1441

406813 Revision D - September 2014

Copyright 2009, Graco Inc. is registered to ISO 9001.

See reverse for assembly directions.

Assembly

NOTE: Apply lithium-based grease whenever instructed to grease.

1. Use all parts in the repair kits, as applicable to your pump. Clean other parts and inspect for damage. Replace as needed.
2. Grease the detent cam (204) and install into housing.
3. Grease the u-cups (208) and install on the piston with lips facing toward the center of the piston.
4. Grease both ends of the piston (202) and install it in the housing, with the flat side toward the cup (213). Be careful not to tear u-cups (208) when sliding piston into housing.
5. **Standard or Pulse Count models (no runaway protection solenoid):** Grease new o-rings (206) and install on the end caps. Install the end caps into the housing.
DataTrak models (with runaway protection solenoid): Invert the air valve, with the air inlet facing away from you. Grease and install new o-ring (206) on right-side end cap. Grease and install new o-ring (206) and the solenoid release button and o-ring (219) on left-side end cap. Install the end caps into the housing.
6. Install a retaining ring on each end to hold end caps in place.
7. Grease and install the detent assembly (203) into the piston. Install the o-ring (214) on the cup (213). Apply a light film of grease to the outside surface of the o-ring and the inside mating surface of the base (212). Install the cup (213) on the base (212). Install the spring (211) onto protrusion on the cup. Install the cup assembly. Align the small round magnet in the base with the air inlet.
8. Grease the cup side and install the valve plate (205). Align the small hole in the plate with the air inlet. Tighten the screws (209) to hold it in place.