

Operating Instructions



309047

Rev. A



This manual contains important warnings and information.
READ AND KEEP FOR REFERENCE.

INSTRUCTIONS

Pressure Roller

Model 243066, Series A

- 20 in. (50 cm) heavy-duty extension
- 45° swivel adapter
- 9 in. (23 cm) roller frame
- 1/2 in. (13 mm) nap roller cover

*3600 psi (24.8 MPa, 248 bar) Maximum Fluid Inlet Pressure **

* This maximum pressure is only possible if the roller frame is completely plugged. The best operating pressure is the lowest pressure that provides an even paint supply to the roller and typically does not exceed 300 psi (2.1 MPa, 21 bar).

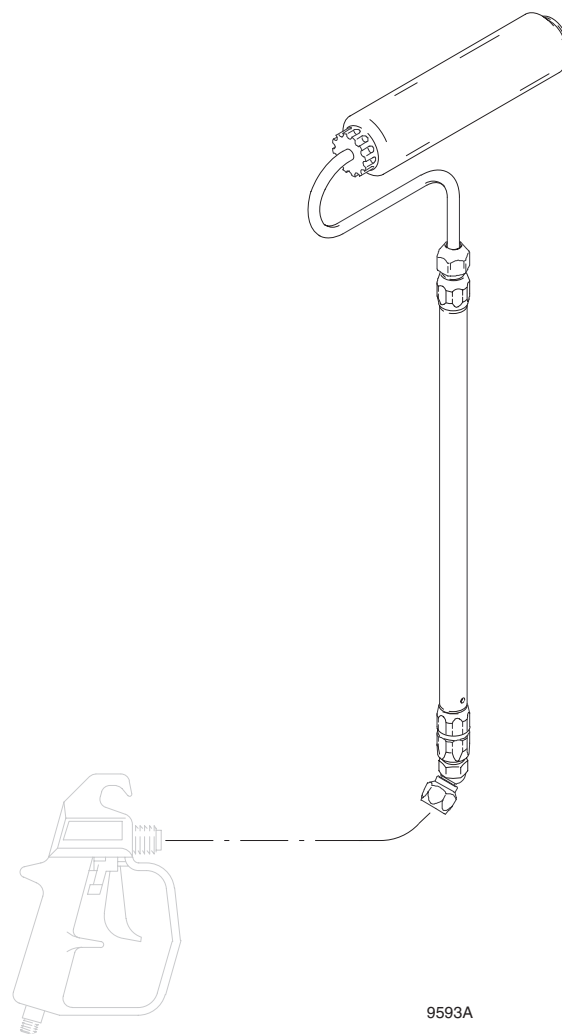







Airless spray
gun not included

GRACO INC. P.O. BOX 1441 MINNEAPOLIS, MN 55440-1441

©COPYRIGHT 2000, GRACO INC.

Graco Inc. is registered to I.S. EN ISO 9001

Warnings and Cautions

 WARNING	
<p>EQUIPMENT MISUSE HAZARD Misuse can cause the equipment to rupture or malfunction and result in serious injury.</p> <p>To help prevent injury</p> <ul style="list-style-type: none"> Do not modify the extension tube or roller frame or use parts not designed for this equipment. Do not use 1,1,1-trichloroethane, methylene chloride, other halogenated hydrocarbon solvents or fluids containing such solvents in this or any other pressurized aluminum equipment. Such use could result in a chemical reaction, with the possibility of explosion. 	 INSTRUCTIONS 
<p>FIRE AND EXPLOSION HAZARD Improper grounding, poor ventilation, open flames or sparks can cause a hazardous condition and result in a fire or explosion and serious injury.</p> <p>To help prevent injury from fire or explosion</p> <ul style="list-style-type: none"> Provide fresh air ventilation to avoid the buildup of flammable fumes from flushing fluids or the coating being applied. Keep the application area free of debris, including solvent, rags, and gasoline. 	 
<p>FLUID INJECTION HAZARD If high-pressure fluid pierces your skin, the injury might look like "just a cut". But it is a serious wound. Get immediate medical attention.</p> <p>To help prevent injection</p> <ul style="list-style-type: none"> Keep your hands and body away from the roller frame when flushing. High pressure fluid emitted from the holes in the frame could cause an injection injury. Always relieve pressure before you check or repair leaks and when you turn off pump or stop painting. Never use components rated less than system <i>Maximum Working Pressure</i>. 	
<p>ELECTROCUTION HAZARD Failure to observe the electrical hazards described below could result in serious injury, including burns or electrocution.</p> <p>To help prevent harmful electrical shock</p> <ul style="list-style-type: none"> Avoid contact with power lines. Follow all grounding instructions in your separate pump and gun instruction manual, and comply with all local, state, and national fire, electrical, and safety regulations. Use only Graco paint hoses. 	

Preventing Corrosion Damage and Freezing

CAUTION

Never leave water in the pump, gun, or pressure roller. Doing so could cause corrosion and damage from freezing. For storage, flush the system with Graco Pump Armor™ or mineral spirits/paint thinner. See **Flushing** on page 3.

Installation

Assemble the pressure roller as shown in the **Parts Drawing** on page 3.

Pressure Relief Procedure

WARNING



psi/MPa/bar

To help prevent injection injuries, follow this procedure whenever you stop painting.

- Put gun trigger safety in SAFETY ON position.
- Shut off power to pump.
- Put pump prime/drain valve (required for pressure relief) in DRAIN position to relieve pressure in system.
- Put gun trigger safety in SAFETY OFF position, and trigger gun to relieve any pressure in hose.
- Put gun trigger safety in SAFETY ON position, and keep pump prime/drain valve in DRAIN position until you paint again.

Operation

- Follow pump priming instructions using lowest pressure setting at which pump primes.
 - Put pump prime/drain valve in position that delivers fluid to hose.
 - Disengage gun safety latch, and trigger gun briefly until paint comes to roller.
 - Experiment with triggering gun and rolling paint.
- NOTE:** Trigger the gun briefly when you need more paint. Determine how often you must trigger the gun to maintain an even paint supply to the roller.
- Increase pump pressure only if triggering gun cannot supply enough paint for your rolling speed.



See **Pressure Relief Procedure** on page 2.

- Whenever you stop painting, **relieve the pressure**, and elevate roller end of extension tube to prevent paint from draining out.

Flush the pump, gun, and pressure roller immediately after each use to prevent paint from drying in the pressure roller and damaging it. See **Flushing** on page 3.

Flushing

This is the procedure for flushing the pressure roller. The pump and gun you are using may have additional flushing steps, such as cleaning filters and screens. See the pump and gun flushing instructions.

NOTE: Leave the pressure roller attached to the gun for this procedure.



See **Pressure Relief Procedure** on page 2.

1. **Relieve the pressure.**
 2. Remove roller cover (6) and diffuser from roller frame as follows (see **Parts Drawing** at right):
 - a. Hold roller cover, and unscrew retaining nut.
 - b. Slide diffuser and roller cover off of roller frame.
 - c. Pull roller cover off of diffuser.
 3. Clean roller cover with compatible fluid, and clean diffuser by shaking vigorously in pail of compatible fluid to remove wet paint. Use soft bristled brush to remove any dried paint on diffuser.
 4. Place roller frame (1) in empty waste pail.
 5. Prime pump with flushing fluid compatible with paint you are using, and use the lowest pressure setting at which pump primes.
 6. Put pump prime/drain valve in position that delivers fluid to hose.
- NOTE:** Perform Step 7 at the lowest pressure possible.
7. Trigger gun until flushing fluid coming out of roller frame is relatively clear.
 8. Shut off the pump, and **relieve the pressure.**
 9. To prevent corrosion, lubricate paint holes in roller frame with lightweight oil that does not contain silicone.

Storage

If you are going to store the airless equipment for an extended period of time after flushing with water-base fluid, flush again with Graco Pump Armor or mineral spirits/paint thinner. Leave the fluid in the system during storage.

Additional Roller Covers

The following pressure roller covers are available at your local distributor:

- 107589** 9 in. (23 cm); 3/8 in. (9.5 mm) nap
- 107590** 9 in. (23 cm); 1/2 in. (13 mm) nap
- 107591** 9 in. (23 cm); 3/4 in. (19 mm) nap
- 107592** 9 in. (23 cm); 1-1/4 in. (32 mm) nap

Parts Drawing

Pressure Roller, Model 243066, Series A

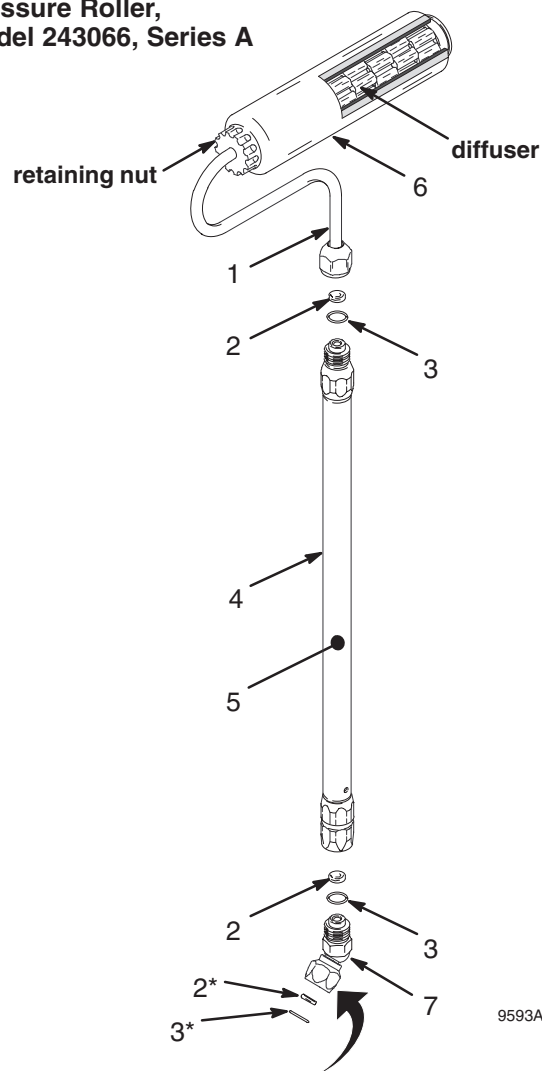

HINT:
When replacing gasket (2*) and o-ring (3*) in swivel adapter (7), position o-ring first, then press gasket into place.

Parts List

Ref. No.	Part No.	Description	Qty.
1	240005	FRAME, roller; 9 in. (23 cm)	1
2	162863	GASKET, non-metallic	3
3	114049	PACKING, o-ring	3
4	232122	TUBE, extension; 20 in. (50 cm)	1
5▲	195804	LABEL, warning	1
6	107590	COVER, roller; 9 in. (23 cm); 1/2 in. (13 mm) nap	1
7	224399	ADAPTER, 45° swivel	1

▲ Call 1-800-328-0211 for free extras.

Graco Warranty

Graco warrants all equipment manufactured by Graco and bearing its name to be free from defects in material and workmanship on the date of sale by an authorized Graco distributor to the original purchaser for use. With the exception of any special, extended, or limited warranty published by Graco, Graco will, for a period of twelve months from the date of sale, repair or replace any part of the equipment determined by Graco to be defective. This warranty applies only when the equipment is installed, operated and maintained in accordance with Graco's written recommendations.

This warranty does not cover, and Graco shall not be liable for general wear and tear, or any malfunction, damage or wear caused by faulty installation, misapplication, abrasion, corrosion, inadequate or improper maintenance, negligence, accident, tampering, or substitution of non-Graco component parts. Nor shall Graco be liable for malfunction, damage or wear caused by the incompatibility of Graco equipment with structures, accessories, equipment or materials not supplied by Graco, or the improper design, manufacture, installation, operation or maintenance of structures, accessories, equipment or materials not supplied by Graco.

This warranty is conditioned upon the prepaid return of the equipment claimed to be defective to an authorized Graco distributor for verification of the claimed defect. If the claimed defect is verified, Graco will repair or replace free of charge any defective parts. The equipment will be returned to the original purchaser transportation prepaid. If inspection of the equipment does not disclose any defect in material or workmanship, repairs will be made at a reasonable charge, which charges may include the costs of parts, labor, and transportation.

THIS WARRANTY IS EXCLUSIVE, AND IS IN LIEU OF ANY OTHER WARRANTIES, EXPRESS OR IMPLIED, INCLUDING BUT NOT LIMITED TO WARRANTY OF MERCHANTABILITY OR WARRANTY OF FITNESS FOR A PARTICULAR PURPOSE.

Graco's sole obligation and buyer's sole remedy for any breach of warranty shall be as set forth above. The buyer agrees that no other remedy (including, but not limited to, incidental or consequential damages for lost profits, lost sales, injury to person or property, or any other incidental or consequential loss) shall be available. Any action for breach of warranty must be brought within two (2) years of the date of sale.

Graco makes no warranty, and disclaims all implied warranties of merchantability and fitness for a particular purpose in connection with accessories, equipment, materials or components sold but not manufactured by Graco. These items sold, but not manufactured by Graco (such as electric motors, switches, hose, etc.), are subject to the warranty, if any, of their manufacturer. Graco will provide purchaser with reasonable assistance in making any claim for breach of these warranties.

In no event will Graco be liable for indirect, incidental, special or consequential damages resulting from Graco supplying equipment hereunder, or the furnishing, performance, or use of any products or other goods sold hereto, whether due to a breach of contract, breach of warranty, the negligence of Graco, or otherwise.

FOR GRACO CANADA CUSTOMERS

The parties acknowledge that they have required that the present document, as well as all documents, notices and legal proceedings entered into, given or instituted pursuant hereto or relating directly or indirectly hereto, be drawn up in English. Les parties reconnaissent avoir convenu que la rédaction du présente document sera en Anglais, ainsi que tous documents, avis et procédures judiciaires exécutés, donnés ou intentés à la suite de ou en rapport, directement ou indirectement, avec les procédures concernées.

ADDITIONAL WARRANTY COVERAGE

Graco does provide extended warranty and wear warranty for products described in the "Graco Contractor Equipment Warranty Program".

Graco Phone Number

TO PLACE AN ORDER, contact your Graco distributor, or call this number to identify the distributor closest to you:
1-800-690-2894 Toll Free

*All written and visual data contained in this document reflect the latest product information available at the time of publication.
Graco reserves the right to make changes at any time without notice.*

Sales Offices: Minneapolis, Detroit

Foreign Offices: Belgium, Korea, Hong Kong, Japan

GRACO INC. P.O. BOX 1441 MINNEAPOLIS, MN 55440-1441

<http://www.graco.com>

PRINTED IN USA 309047 02/2000