

G3 Stirring Paddle Replacement Kit

3A0535E
EN

Instructions for replacing stirring paddle. For professional use only.

Part No.: 571044, 571045, 571046, 571047



Important Safety Instructions

Read all warnings and instructions in this manual and the G3 Pump instruction manual that was included with your unit. Save these instructions.

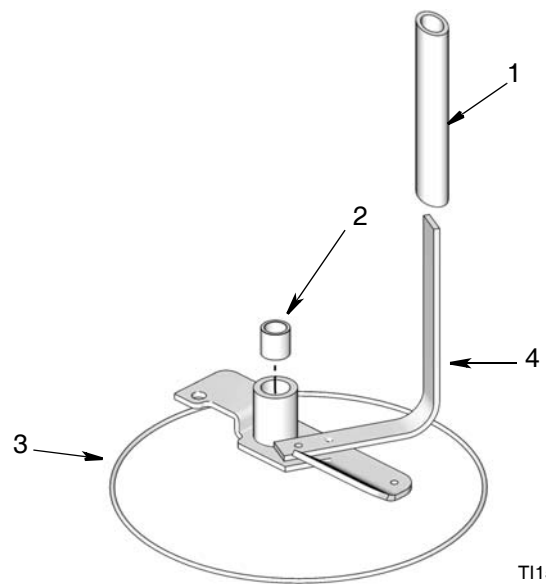



TI15457

2 Liter Model shown

Kit Parts

Ref.	Description	Qty
1	WIPER, stirring	1
2	BEARING, sleeve	1
3	O-RING, 258, green	1
4	PADDLE, stirring	1

Pressure Relief

					
SKIN INJECTION HAZARD					
High-pressure fluid from dispense device, hose leaks, or ruptured components will pierce skin. This may look like just a cut, but it is a serious injury that can result in amputation. Get immediate surgical treatment.					
Follow Pressure Relief Procedure in this manual, when you stop dispensing and before cleaning, checking, or servicing equipment.					

Relieve pressure in system by using two wrenches working in opposite directions on pump element and pump element fitting to **only** loosen fitting.

NOTE: When loosening pump element fitting, do NOT loosen **pump element**. Loosening pump element will change the output volume.

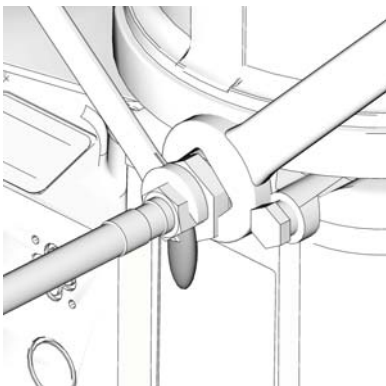

TI14711

FIG. 1

Instructions

Reference numbers used in these instructions correspond to parts included in Kit and are provided on page 1. Parts identified with an alpha character are user provided, already installed components or locations necessary to correctly complete these instructions.

Disassembly

NOTE: Unless otherwise noted, all illustrations show 2L pump models.

1. Disconnect power source.
2. Relieve pressure using Pressure Relief Procedure provided.
3. **For 2 Liter models only:** use a strap wrench around reservoir (a) to turn reservoir 1/4 turn counter-clockwise (FIG. 2).

For 4L or larger reservoirs: be sure strap wrench is positioned around the lower portion of the reservoir. Turn reservoir counter-clockwise approximately to full turns until it is loose enough to remove it from reservoir adapter.

If the reservoir and adapter come off the pump as a single unit, it is not necessary to separate the reservoir from the adapter.

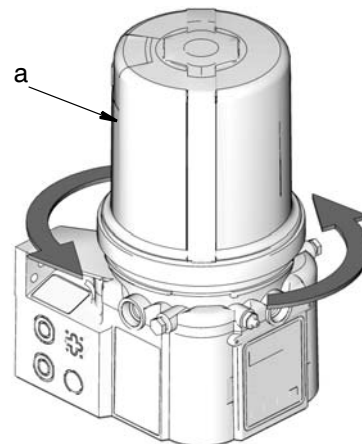

TI15454

FIG. 2

4. Remove reservoir (a) and o-ring (b) from (FIG. 3). Discard o-ring (b).

2 Liter Models

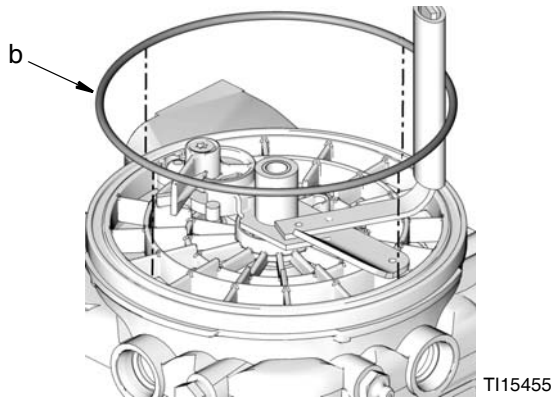

4 Liter and Larger Models

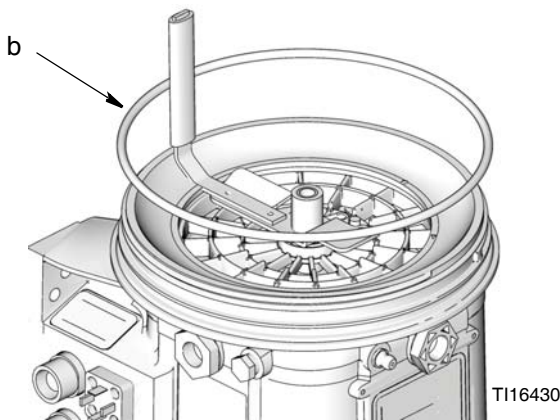

FIG. 3

5. Step 5 (a - d) is for G3 Pumps with a follower plate ONLY:

- a. Verify the following parts were removed with reservoir (FIG. 4):
 - Spring (S)
 - Follower Pate (FP)
 - Follower Plate Seal (FPS)
 - Rod (R)

NOTE: If the reservoir and adapter were not separated, the follower plate components may stay inside.

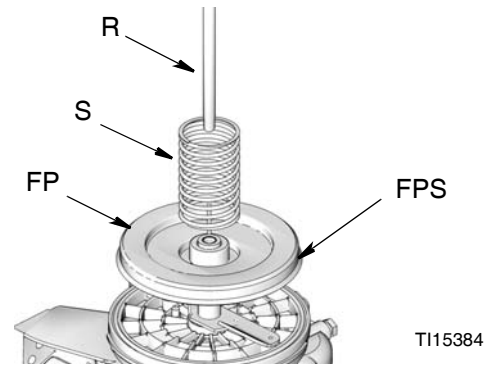

FIG. 4

- b. Remove any parts still installed in the G3 base.
- c. Be sure parts remaining in reservoir were removed (if possible) to reuse them for reassembly.
- d. Examine follower plate seal (FPS) for wear or damage. If it is damaged, it must be replaced. Part No. 278139 is available from Graco. Contact customer service to order this part or your local Graco distributor.

NOTE: For models that include a Low Level paddle and/or follower plate, be careful when removing stirring paddle from G3 that bearing (2) does not fall into the unit.

6. **For all installations**, turn paddle (d) **clockwise** to loosen and remove it from G3 base (FIG. 5).

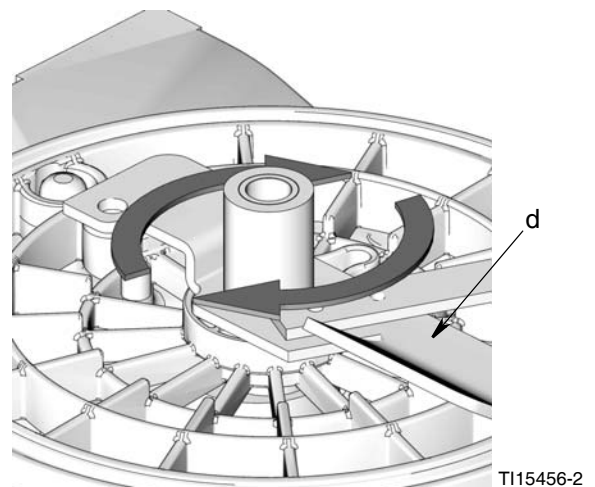

FIG. 5

7. **Step 7 (a - b) is for G3 Pumps with Low Level Paddle ONLY:**

- a. Remove bolt (f) and washers (g) holding low level paddle (e) to stirring paddle (d) and completely separate these parts from stirring paddle. Keep bolt and washers for reassembly (FIG. 6).

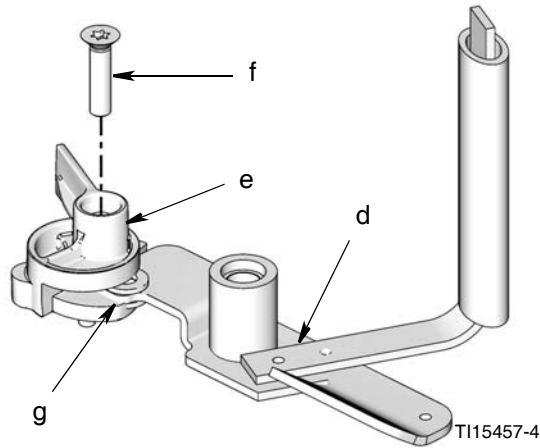

FIG. 6

- b. Examine the low level paddle (e), if undamaged it can be reused. If damaged, a replacement low level paddle, part no. 278136 is available from Graco customer service.

8. **For all installations,** discard old stirring paddle (d) (this part is not reused).

Reassembly

Always use new parts from kit when available.

1. Lightly grease stirring paddle arm (4a) with same grease you are using in the pump (FIG. 7).

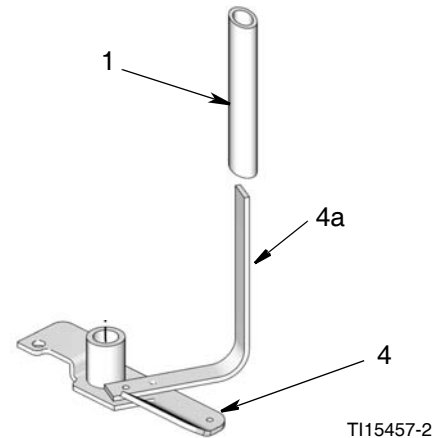

FIG. 7

2. Slide wiper (1) over arm (4a) on stirring paddle (4) (FIG. 7).
3. **Step 3 (a - g) is for G3 Pumps with Low Level Paddle ONLY. If your G3 Pump model does not include a Low Level paddle, continue installation with Step 4, page 5.**

To assemble low level paddle to stirring paddle (4):

- a. Align washers (g), with hole in the base (h) of the stirring paddle (4). One washer should be on the top of the hole and one on the bottom (underside) as shown in FIG. 8.

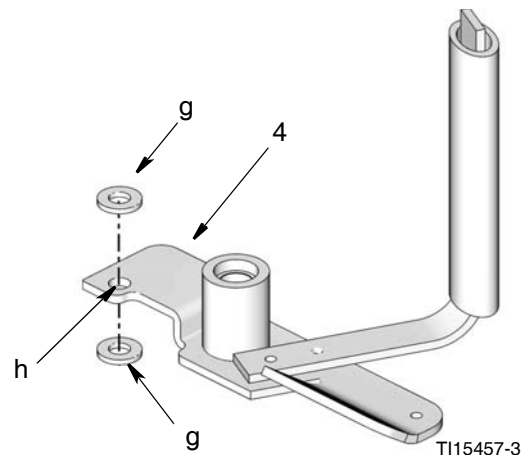

FIG. 8

- b. Examine low level paddle (e). It is designed with a slot / gap on one side.

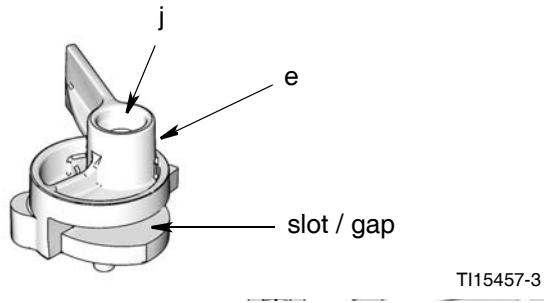

FIG. 9

- c. To correctly assemble the low level paddle (e) to the stirring paddle (4), slide the stirring paddle and washers into the slot / gap (FIG. 10).

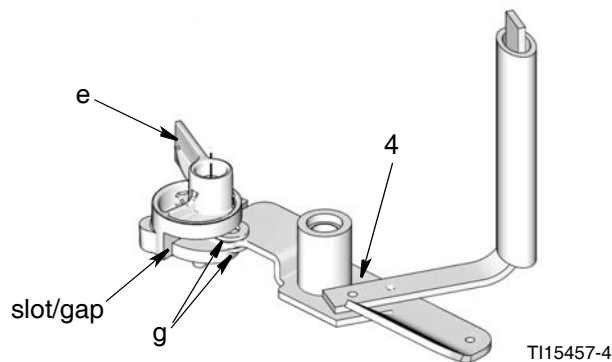

FIG. 10

- d. Align hole (j) in top of low level paddle (e) with hole in center of washers (g) and stirring paddle (4) (FIG. 11).
- e. Insert bolt (f), making sure it passes through the low level paddle (e), holes in washers (g) and

base of stirring paddle (4) (FIG. 11).

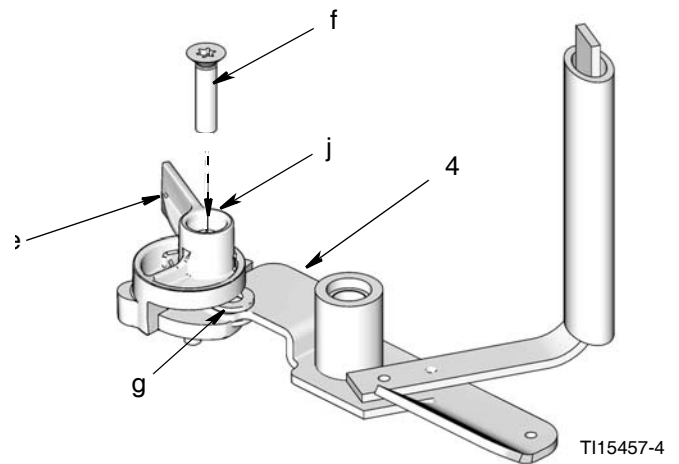

FIG. 11

- f. Using a screwdriver, tighten bolt (d). Torque bolt to 4 in. lbs (0.45 N•m). Bolt should be tight enough to hold low level paddle securely in place while still allowing the paddle to move freely back and forth. It also must not protrude from the bottom of low level paddle (e).

NOTE: Over tightening bolt (d) will cause low level paddle to not function.

- g. Install bearing (2) in paddle (4) as shown in FIG. 12.

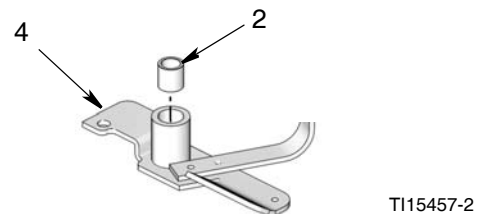

FIG. 12

4. Install stirring paddle (4) in base of G3. Turn paddle **counter-clockwise** until it is tighten securely in place (FIG. 13). (Illustration does NOT show low level paddle.)

NOTE: If a low level paddle (e) is installed, to prevent damage, hold low level paddle in its full out

position while installing stirring paddle (FIG. 14).

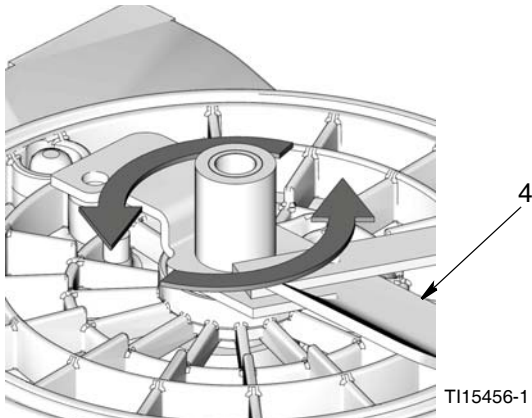

FIG. 13

5. **Step 5 (a - g) is for G3 Pumps with a follower plate ONLY. If your G3 Pump does not include a follower plate, continue Reservoir Installation instructions, page 7.**

- a. Verify low level paddle (e) is in full out position as shown in FIG. 14.

TI15456-4

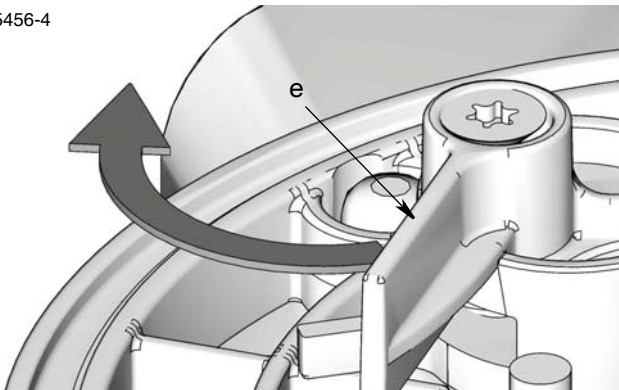

FIG. 14

- b. Install follower plate (FP) on stirring paddle (4). Be sure the seal (FPS) is facing down (toward

ricer plate) as shown in FIG. 15.

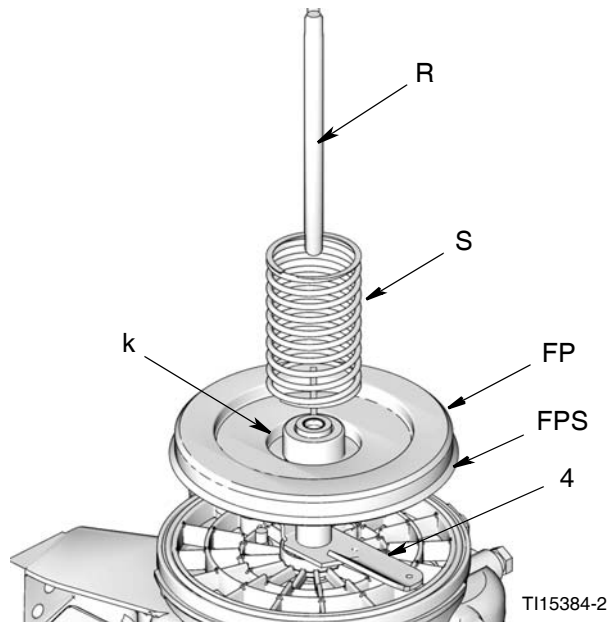

FIG. 15

- c. Install spring (S) into spring pocket (k).
- d. Install Rod (R) into reservoir (a).
- e. Slide rod (R) through center of spring (S) and follower plate (FP).
- f. Seat spring (S) in spring pocket in top of reservoir (a).
- g. Compress spring (S) to install reservoir (a). See Reservoir Installation instructions.

Reservoir Installation - 2 Liter Models Only

1. Grease new o-ring (3) (included in kit) and install o-ring in ricer plate groove (c) (FIG. 3).

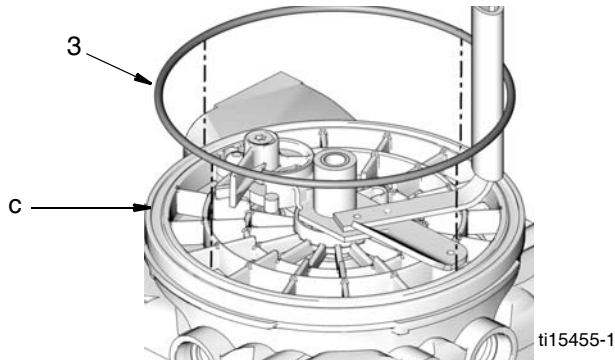

FIG. 16

2. Install reservoir (a) with vent (m) facing toward the rear left (n) of the G3 base. See FIG. 17 for correct orientation of these parts to ensure proper installation.

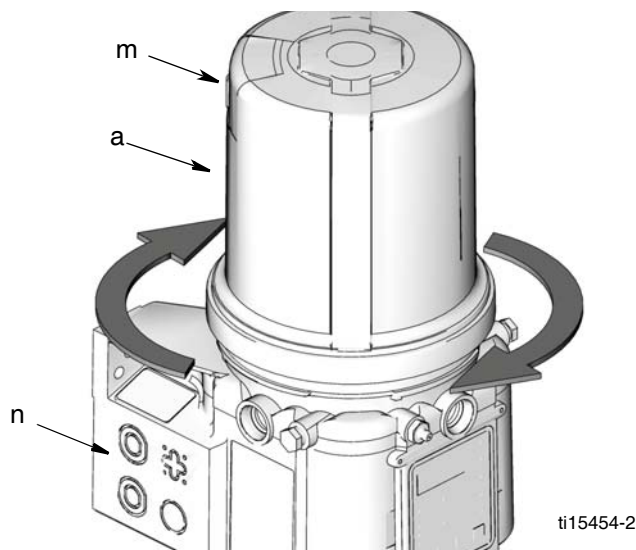

FIG. 17

3. Position strap wrench over reservoir and use it to turn reservoir 1/4 turn clockwise till reservoir will not turn any farther.

NOTICE

Be careful when installing reservoir that o-ring is not pinched. If the o-ring is not correctly installed, grease could leak out of the bottom of the G3 reservoir.

Reservoir Installation - 4 Liter and Larger Models Only

1. Grease new o-ring (3) (included in kit) and install o-ring around reservoir adapter (p) as shown in (FIG. 18).

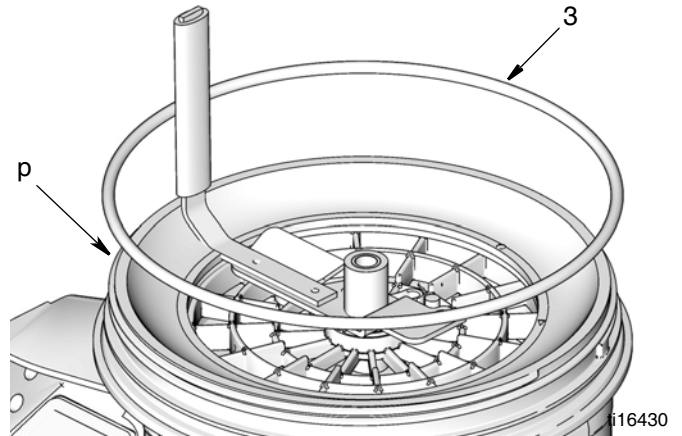

FIG. 18

2. Reservoir Installation onto Adapter

Install reservoir onto adapter. Position strap wrench around lower portion of reservoir as indicated in FIG. 19 and use it to turn the reservoir clockwise to tighten it to the base.

To ensure the reservoir is tightened sufficiently, but not over tightened:

- a. First turn reservoir clockwise one full turn.
- b. Then continue to turn the reservoir clockwise for a second turn until the vent (q) in the reservoir faces the back of the G3 pump and the horizontal lines (r) molded into the reservoir align with the pump outlets (s) on each side of the pump base as shown in FIG. 19.

Reservoir with Adapter Installation

If the reservoir and adapter remained assembled during disassembly, install them on the pump base.

Position a strap wrench around the lower portion of the reservoir as indicated in FIG. 19. Turn reservoir clockwise 1/4 turn to tighten it to the base.

- c. When reservoir is correctly aligned and tightened to the base you will have turned it approximately 2 full turns.

NOTE: Be careful to not overtighten reservoir.

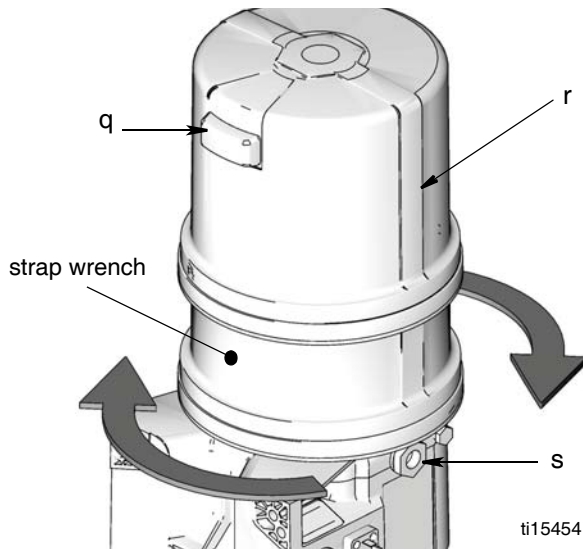

FIG. 19

All written and visual data contained in this document reflects the latest product information available at the time of publication. Graco reserves the right to make changes at any time without notice.

Original instructions. This manual contains English. MM 3A0535

Graco Headquarters: Minneapolis
International Offices: Belgium, China, Japan, Korea
GRACO INC. P.O. BOX 1441 MINNEAPOLIS, MN 55440-1441

Copyright 2010, Graco Inc. is registered to ISO 9001

www.graco.com
2010, revised April 2014